

Building Sketch (Page - 1)

Borrower/Client Jeffrey & Gail King			
Property Address 46 Pascal Lane			
City Austin	County Travis	State TX	Zip Code 78746
Lender Citigroup Private Bank			

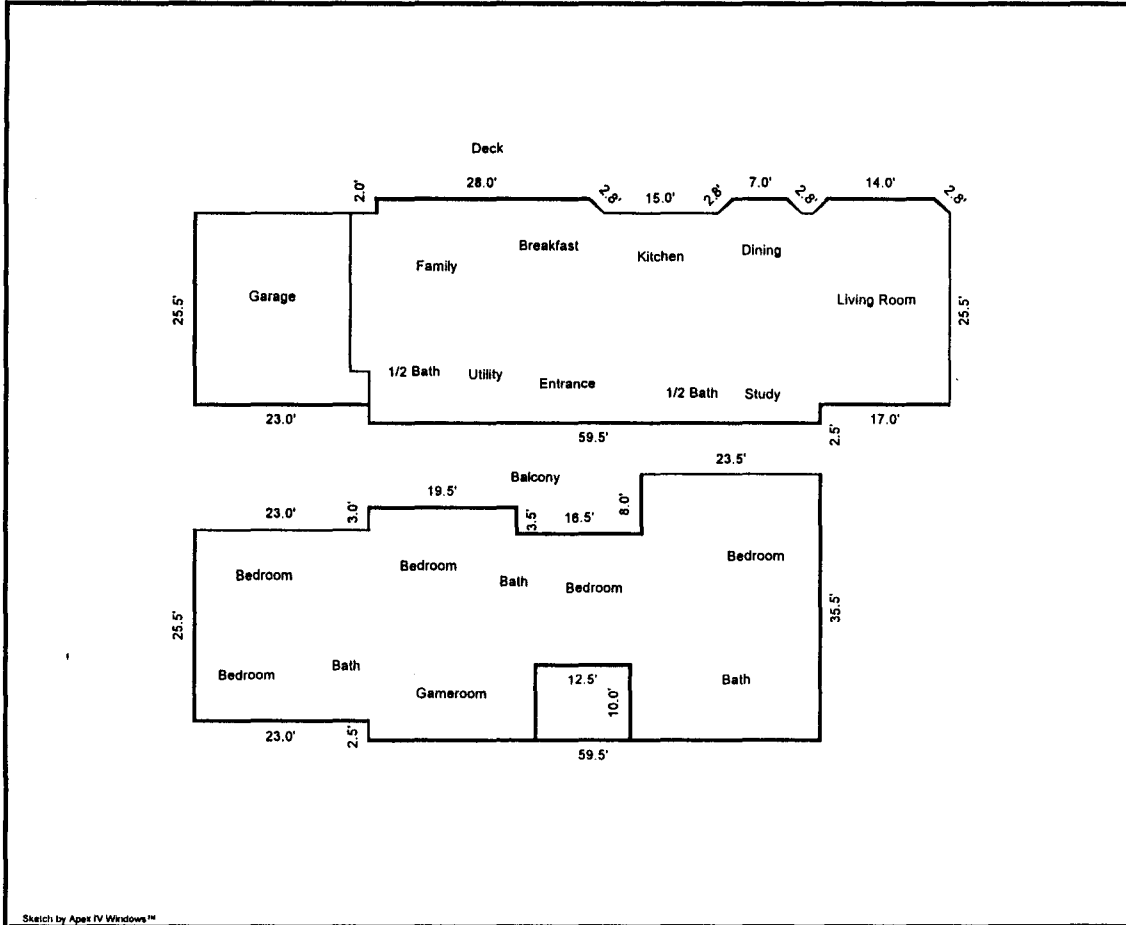

Sketch by Apex IV Windows™

Comments:

AREA CALCULATIONS SUMMARY			
Code	Description	Size	Net Totals
GLA1	First Floor	2260.00	2260.00
GLA2	Second Floor	2479.00	
	Open	-125.00	2354.00
GAR	Garage	534.00	534.00
TOTAL LIVABLE (rounded)			4614

LIVING AREA BREAKDOWN			
Breakdown			Subtotals
First Floor			
	21.0 x	59.5	1249.50
	2.0 x	7.0	14.00
0.5 x	2.0 x	2.0	2.00
0.5 x	2.0 x	2.0	2.00
	7.0 x	57.0	399.00
	2.5 x	28.0	70.00
	17.0 x	25.5	433.50
	2.0 x	14.0	28.00
0.5 x	2.0 x	2.0	2.00
0.5 x	2.0 x	2.0	2.00
0.5 x	2.0 x	2.0	2.00
	2.0 x	28.0	56.00
Second Floor			
	23.0 x	25.5	586.50
	27.5 x	59.5	1636.25
	8.0 x	23.5	188.00
	3.5 x	19.5	68.25
Open			
	10.0 x	12.5	-125.00
17 Calculations Total (rounded)			4614